

STATE OF NORTH CAROLINA
DEPARTMENT OF TRANSPORTATION
HIGHWAY DIVISION 6

PLANS

Let Date: October 16, 2024

CONTRACT ID: DF00492

TIP NO.: -----

FEDERAL AID NO.: STATE FUNDED

WBS ELEMENT NO.: 2025CPT.06.05.20092.1 & 2025.06.05.20092.2

ROUTE NO.: VARIOUS

LOCATION: VARIOUS

COUNTY: BLADEN

**TYPE OF WORK: ASPHALT SURFACE TREATMENT – DOUBLE SEALS & TRIPLE SEALS & HOT
POURED RUBBER ASPHALT JOINT SEALER**

LENGTH OF PROJECT: 46.36 MILES

Bladen County AST Fall 2024

Contract: DF00492



Proposed Treatment

- Seal - Double WBS: 2025CPT.06.05.20092.1
- Seal - Triple WBS: 2025CPT.06.05.20092.2

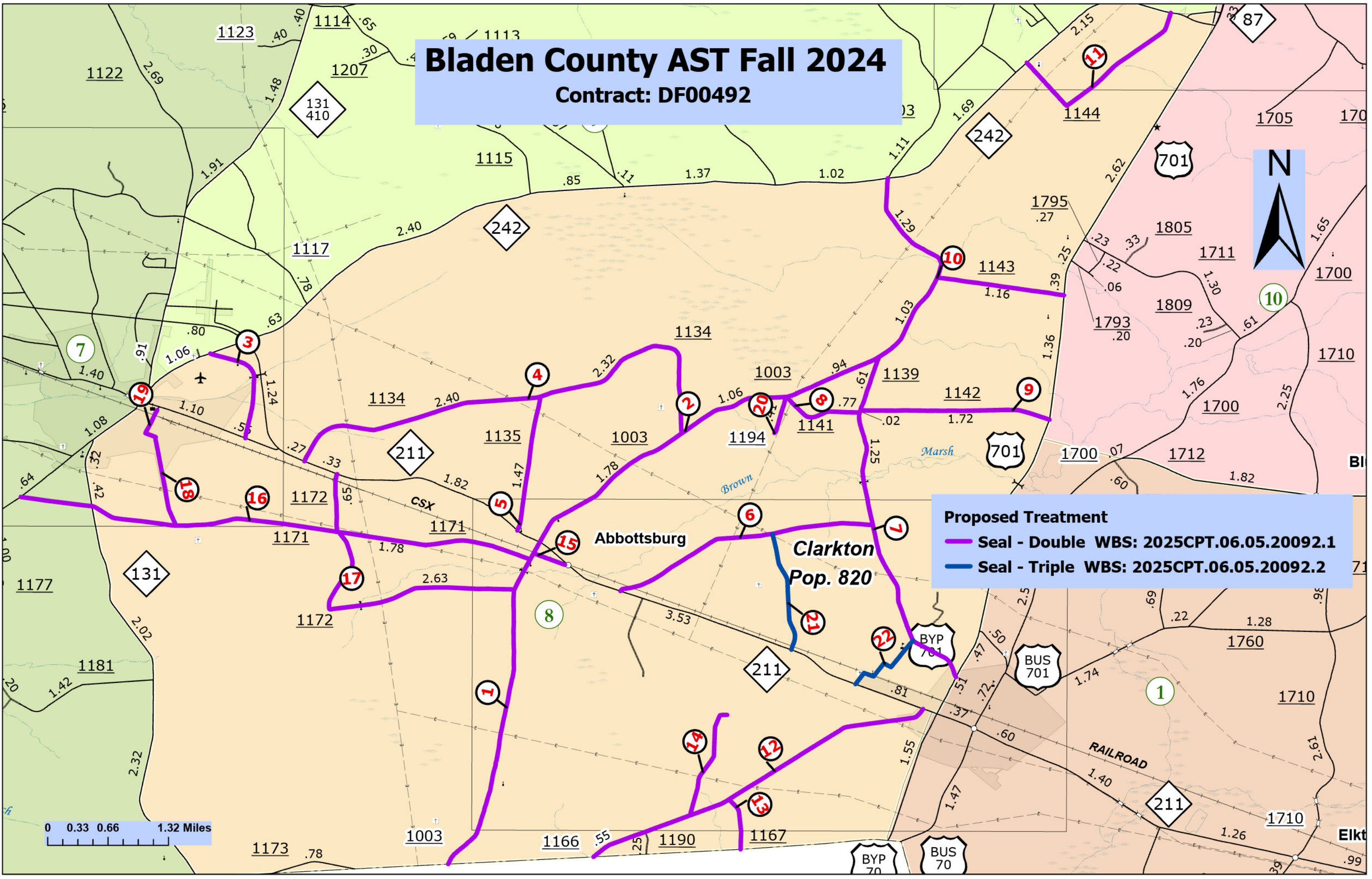

SIGNING FOR ASPHALT SURFACE TREATMENT

LEGEND	
	PORTABLE SIGN
	STATIONARY SIGN
	DIRECTION OF TRAFFIC FLOW

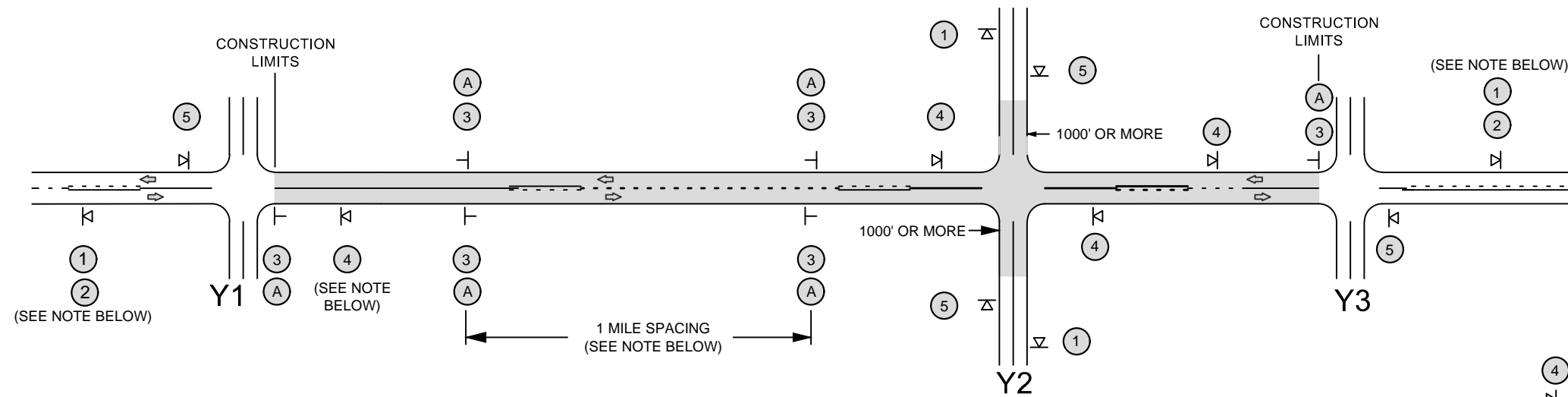

MAINLINE (-L-) SIGNING

-Y- LINE SIGNING

SIGNING NOTES AND PLACEMENT PER DIRECTION	①		- PLACE 1000' PRIOR TO BEGINNING OF CONSTRUCTION LIMITS. ONLY USED ON -Y- LINES IF RESURFACING LIMITS EXTEND 1000' ALONG -Y- LINE.
	②		- SIGN #2 ONLY USED WHEN RESURFACING LIMITS ARE 2 OR MORE MILES IN LENGTH. ROUND UP TO THE NEAREST WHOLE NUMBER. DO NOT USE FRACTIONAL OR DECIMAL NUMBERS.
	③	 	- ALTERNATE THE FOLLOWING TWO SIGNS: - STARTING WITH "LOOSE GRAVEL" (W8-7) FOLLOWED BY "UNMARKED PAVEMENT". - PLACE INITIALLY AT THE CONSTRUCTION LIMITS AND SPACED 1 MILE APART THEREAFTER. - AT TEE INTERSECTIONS INSTALL INITIALLY 0.5 MILE FROM INTERSECTION AND SPACE 1 MILE APART THEREAFTER.
	A		PLACE INITIALLY AT THE CONSTRUCTION LIMITS AND SPACED 1 MILE APART THEREAFTER. IF NO -Y- LINES EXIST, PLACE 2ND SET 1/2 MILE FROM THE CONSTRUCTION LIMITS AND THEN SPACE 1 MILE THEREAFTER. SPEED LIMIT SIGN MAY BE PLACED ON SAME POST AS LOOSE GRAVEL SIGN, IF DESIRED.
	④		- THESE ARE FOR -Y- LINES THAT ARE "THROUGH" ROADWAYS. DEAD END AND SUBDIVISION ROADS ARE NOT "THROUGH" ROADWAYS. - INSTALL 500' +/- FROM EACH -Y- LINE APPROACH AS SHOWN ABOVE. - FOR MULTIPLE -Y- LINES THAT ARE SEPARATED BY 0.25 MILES OR LESS, TREAT AS A SINGLE UNIT AND INSTALL WITHIN 500' OF EACH APPROACH. - A MAXIMUM OF 2 SIGN SETS PER MILE. DO NOT INSTALL WHEN -Y- LINES ARE WITHIN 0.5 MILES FROM "END ROAD WORK" SIGN.
	⑤		PLACE 500' FOLLOWING THE END OF CONSTRUCTION LIMITS OR AS SHOWN WHEN WORK ENDS AT A 3-WAY TEE INTERSECTION.
THE ABOVE SIGNS ARE ALL THAT ARE REQUIRED FOR A CONTRACTOR TO BEGIN A RESURFACING CONTRACT. ANY ADDITIONAL SIGNS REQUESTED BY NCDOT DIVISIONS SHALL BE INSTALLED WITHIN 7 BUSINESS DAYS OF THE START OF CONTRACT WORK.			
MAPS LESS THAN 2 MILES		FOR AST RESURFACING MAPS WITH CONSTRUCTION LIMITS LESS THAN 2 MILES IN LENGTH, USE A STATIONARY "LOOSE GRAVEL" SIGN AT THE BEGINNING CONSTRUCTION LIMIT FOLLOWED BY AN "UNMARKED PAVEMENT" SIGN MIDWAY THROUGH AND AN "END ROAD WORK" SIGN AT THE END CONSTRUCTION LIMIT.	

STATIONARY SIGNING NOT REQUIRED FOR THE FOLLOWING -Y- LINE CONDITIONS:

- 1) LESS THAN 1000' OF RESURFACING ALONG -Y- LINE
- 2) SUBDIVISION ROADS
- 3) DEAD END ROADS

WHEN PAVING/CONSTRUCTION ACTIVITIES PROCEED ACROSS AN UNSIGNED -Y- LINE, PORTABLE ADVANCE WARNING SIGNS SHALL BE USED ALONG THE -Y- LINE AS SHOWN BELOW. REMOVE UPON COMPLETION OF WORK.



NOTE:
IT IS THE CONTRACTOR'S RESPONSIBILITY TO ENSURE THE PROPER PLACEMENT AND LOCATION OF WORK ZONE SIGNING PER THE STANDARD DRAWING. NCDOT HAS THE RIGHT TO INSPECT THE PLANNED LOCATIONS AND REQUIRE ADJUSTMENT BY THE CONTRACTOR, AS NEEDED, OR AS DIRECTED BY THE ENGINEER.

TEE INTERSECTION

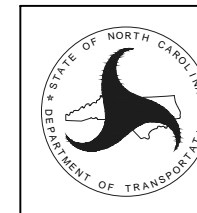
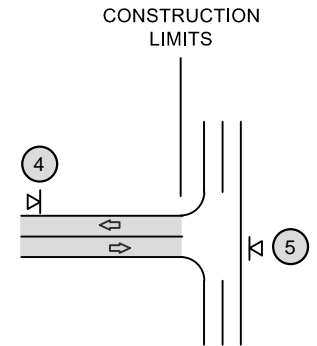

REVISED - 12-13-2018
NCDOT - DIVISION 6
ADVANCE WARNING SIGNS FOR 2-LANE ROADWAY ASPHALT SURFACE TREATMENT

PROJECT NO.	SHEET NO.	TOTAL NO.
2025CPT.06.05.20092.1, 2025CPT.06.05.20092.2		

SUMMARY OF QUANTITIES

PROJECT NO	COUNTY	MAP NO	ROUTE	DESCRIPTION	TYP NO	LANES	LANE TYPE	FINAL SURFACE TESTING REQUIRED	WARM MIX ASPHALT REQUIRED	LENGTH	WIDTH	BEGIN MP	END MP	1702000000-E	1803500000-E	1836000000-E	1838000000-E
														SEAL EXISTING PAVEMENT CRACKS & JOINTS	ASPHALT SURFACE TREATMENT, DOUBLE SEAL	ASPHALT SURFACE TREATMENT, TRIPLE SEAL	EMULSION FOR ASPHALT SURFACE TREATMENT
														LB	SY	SY	GAL
2025CPT.06.05.20092.1	Bladen	1	SR-1003 / TWISTED HICKORY RD	FROM COLUMBUS CO. TO NC 211	1	2		NO	NO	3.68	24	0	3.68	11,040	51,815		31,607
TOTAL FOR MAP NO. 1										3.68				11,040	51,815		31,607
2025CPT.06.05.20092.1	Bladen	2	SR-1003 / TWISTED HICKORY RD	FOM NC 211 TO NC 242	2	2		NO	NO	6.07	24	3.72	9.79		85,466		52,134
TOTAL FOR MAP NO. 2										6.07					85,466		52,134
2025CPT.06.05.20092.1	Bladen	3	SR-1133 / BLADENBORO AIRPORT RD	FROM NC 211 BUS TO NC 242	2	2		NO	NO	1.18	21	0	1.18		14,538		8,868
TOTAL FOR MAP NO. 3										1.18					14,538		8,868
2025CPT.06.05.20092.1	Bladen	4	SR-1134 / BURNEY RD	FROM NC 211 BUS TO NC 242	1	2		NO	NO	4.72	20	0	4.72	14,160	55,382		33,783
TOTAL FOR MAP NO. 4										4.72				14,160	55,382		33,783
2025CPT.06.05.20092.1	Bladen	5	SR-1135 / WRIGHT RD	FROM NC 211 TO SR 1134	1	2		NO	NO	1.47	21	0	1.47	4,410	18,111		11,048
TOTAL FOR MAP NO. 5										1.47				4,410	18,111		11,048
2025CPT.06.05.20092.1	Bladen	6	SR-1136 / WHITE MCEWEN RD	FROM SR 1139 TO NC 211	1	2		NO	NO	2.48	18	0	2.48	7,440	26,189		15,976
TOTAL FOR MAP NO. 6										2.48				7,440	26,189		15,976
2025CPT.06.05.20092.1	Bladen	7	SR-1139 / MITCHELL FORD RD	FROM SR 1003 TO US 701	1	2		NO	NO	3.78	24	0	3.78	11,340	53,223		32,466
TOTAL FOR MAP NO. 7										3.78				11,340	53,223		32,466
2025CPT.06.05.20092.1	Bladen	8	SR-1141 / AUTRY RD	FROM SR 1003 TO SR 1139	1	2		NO	NO	0.77	21	0	0.77	2,310	9,487		5,787
TOTAL FOR MAP NO. 8										0.77				2,310	9,487		5,787
2025CPT.06.05.20092.1	Bladen	9	SR-1142 / CAMPBELL RD	FROM SR 1139 TO US 701	1	2		NO	NO	1.72	20	0	1.72	5,160	20,182		12,311
TOTAL FOR MAP NO. 9										1.72				5,160	20,182		12,311
2025CPT.06.05.20092.1	Bladen	10	SR-1143 / BRITT RD	FROM SR 1003 TO US701	1	2		NO	NO	1.16	21	0	1.16	3,480	15,720		9,590
TOTAL FOR MAP NO. 10										1.16				3,480	15,720		9,590
2025CPT.06.05.20092.1	Bladen	11	SR-1144 / BALDWIN BRANCH CHURCH RD	FROM NC 242 TO NC 242	1	2		NO	NO	2	21	0	2	6,000	24,640		15,031
TOTAL FOR MAP NO. 11										2				6,000	24,640		15,031
2025CPT.06.05.20092.1	Bladen	12	SR-1166 / S PAGE RD	FROM COLUMBUS CO. TO NC 211	1	2		NO	NO	3.45	20	0	3.45	10,350	40,480		24,693
TOTAL FOR MAP NO. 12										3.45				10,350	40,480		24,693
2025CPT.06.05.20092.1	Bladen	13	SR-1167 / LANIER RD	FROM SR 1166 TO END OF PAVEMENT	1	2		NO	NO	0.45	20	0	0.45	1,350	5,280		3,221
TOTAL FOR MAP NO. 13										0.45				1,350	5,280		3,221
2025CPT.06.05.20092.1	Bladen	14	SR-1168 / BRIDGERS RD	FROM SR 166 TO DEAD END	1	2		NO	NO	1.21	20	0	1.21	3,630	14,198		8,661
TOTAL FOR MAP NO. 14										1.21				3,630	14,198		8,661
2025CPT.06.05.20092.1	Bladen	15	SR-1170 / BRADSHAW RD	FROM NC 211 BUS TO SR 1003	1	2		NO	NO	0.31	21	0	0.31	930	3,820		2,330
TOTAL FOR MAP NO. 15										0.31				930	3,820		2,330
2025CPT.06.05.20092.1	Bladen	16	SR-1171 / OLD ABBOTTSBURG RD	FROM NC 410 TO SR1003	1	2		NO	NO	4.73	22	0	4.73	14,190	61,049		37,240
TOTAL FOR MAP NO. 16										4.73				14,190	61,049		37,240
2025CPT.06.05.20092.1	Bladen	17	SR-1172 / GRIMSLEY FARM RD	FROM SR 1003 TO NC 211	1	2		NO	NO	3.28	20	0	3.28	9,840	38,485		23,477
TOTAL FOR MAP NO. 17										3.28				9,840	38,485		23,477
2025CPT.06.05.20092.1	Bladen	18	SR-1174 / 5TH ST	FROM SR 1171 TO SR 1175	1	2		NO	NO	0.99	20	0	0.99	2,970	11,616		7,086
TOTAL FOR MAP NO. 18										0.99				2,970	11,616		7,086
2025CPT.06.05.20092.1	Bladen	19	SR-1175 / 4TH ST	FROM NC 211 BUS TO SR 1174	1	2		NO	NO	0.38	21	0.04	0.42	1,140	4,682		2,856
TOTAL FOR MAP NO. 19										0.38				1,140	4,682		2,856
2025CPT.06.05.20092.1	Bladen	20	SR-1194 / OLD FIELD CEMETERY RD	FROM SR 1003 TO DEAD END	1	2		NO	NO	0.39	21	0	0.39	1,170	4,805		2,931
TOTAL FOR MAP NO. 20										0.39				1,170	4,805		2,931
TOTAL FOR PROJ NO. 2025CPT.06.05.20092.1										44.22				110,910	559,168		341,096
2025CPT.06.05.20092.2	Bladen	21	SR-1137 / MCKEE RD	FROM SR 1136 TO NC 211	3	2		NO	NO	1.3	21	0	1.3	3,900		16,016	14,255
TOTAL FOR MAP NO. 21										1.3				3,900		16,016	14,255
2025CPT.06.05.20092.2	Bladen	22	SR-1138 / BOOKER T WASHINGTON SCHOOL RD	FROM SR 1139 TO NC 211	3	2		NO	NO	0.84	19	0	0.84	2,520		9,364	8,334
TOTAL FOR MAP NO. 22										0.84				2,520		9,364	8,334
TOTAL FOR PROJ NO. 2025CPT.06.05.20092.2										2.14				6,420		25,380	22,589
GRAND TOTAL										46.36				117,330	559,168	25,380	363,685

PROJECT NO.	SHEET NO.	TOTAL NO.
5.20092.1, 2025CPT		

THERMOPLASTIC AND PAINT QUANTITIES

PROJECT NO	COUNTY	MAP NO	ROUTE	DESCRIPTION	TYP NO	LANES	LANE TYPE	LENGTH	WIDTH	BEGIN MP	END MP	4413000000-E	4457000000-N
												WORK ZONE	TEMPORARY
												ADVANCE/GENERAL WARNING SIGNING	TRAFFIC CONTROL
								MI	FT			SF	LS
2025CPT.06.05.20092.1	Bladen	1	SR-1003 / TWISTED HICKORY RD	FROM COLUMBUS CO. TO NC 211	1	2		3.68	24	0	3.68	237	0.08
TOTAL FOR MAP NO. 1								3.68				237	0.08
2025CPT.06.05.20092.1	Bladen	2	SR-1003 / TWISTED HICKORY RD	FOM NC 211 TO NC 242	2	2		6.07	24	3.72	9.79	390	0.13
TOTAL FOR MAP NO. 2								6.07				390	0.13
2025CPT.06.05.20092.1	Bladen	3	SR-1133 / BLADENBORO AIRPORT RD	FROM NC 211 BUS TO NC 242	2	2		1.18	21	0	1.18	80	0.03
TOTAL FOR MAP NO. 3								1.18				80	0.03
2025CPT.06.05.20092.1	Bladen	4	SR-1134 / BURNEY RD	FROM NC 211 BUS TO NC 242	1	2		4.72	20	0	4.72	265	0.10
TOTAL FOR MAP NO. 4								4.72				265	0.10
2025CPT.06.05.20092.1	Bladen	5	SR-1135 / WRIGHT RD	FROM NC 211 TO SR 1134	1	2		1.47	21	0	1.47	72	0.03
TOTAL FOR MAP NO. 5								1.47				72	0.03
2025CPT.06.05.20092.1	Bladen	6	SR-1136 / WHITE MCEWEN RD	FROM SR 1139 TO NC 211	1	2		2.48	18	0	2.48	135	0.05
TOTAL FOR MAP NO. 6								2.48				135	0.05
2025CPT.06.05.20092.1	Bladen	7	SR-1139 / MITCHELL FORD RD	FROM SR 1003 TO US 701	1	2		3.78	24	0	3.78	288	0.08
TOTAL FOR MAP NO. 7								3.78				288	0.08
2025CPT.06.05.20092.1	Bladen	8	SR-1141 / AUTRY RD	FROM SR 1003 TO SR 1139	1	2		0.77	21	0	0.77	64	0.02
TOTAL FOR MAP NO. 8								0.77				64	0.02
2025CPT.06.05.20092.1	Bladen	9	SR-1142 / CAMPBELL RD	FROM SR 1139 TO US 701	1	2		1.72	20	0	1.72	64	0.04
TOTAL FOR MAP NO. 9								1.72				64	0.04
2025CPT.06.05.20092.1	Bladen	10	SR-1143 / BRITT RD	FROM SR 1003 TO US701	1	2		1.16	21	0	1.16	121	0.03
TOTAL FOR MAP NO. 10								1.16				121	0.03
2025CPT.06.05.20092.1	Bladen	11	SR-1144 / BALDWIN BRANCH CHURCH RD	FROM NC 242 TO NC 242	1	2		2	21	0	2	121	0.04
TOTAL FOR MAP NO. 11								2				121	0.04
2025CPT.06.05.20092.1	Bladen	12	SR-1166 / S PAGE RD	FROM COLUMBUS CO. TO NC 211	1	2		3.45	20	0	3.45	228	0.08
TOTAL FOR MAP NO. 12								3.45				228	0.08
2025CPT.06.05.20092.1	Bladen	13	SR-1167 / LANIER RD	FROM SR 1166 TO END OF PAVEMENT	1	2		0.45	20	0	0.45	72	0.01
TOTAL FOR MAP NO. 13								0.45				72	0.01
2025CPT.06.05.20092.1	Bladen	14	SR-1168 / BRIDGERS RD	FROM SR 166 TO DEAD END	1	2		1.21	20	0	1.21	72	0.03
TOTAL FOR MAP NO. 14								1.21				72	0.03
2025CPT.06.05.20092.1	Bladen	15	SR-1170 / BRADSHAW RD	FROM NC 211 BUS TO SR 1003	1	2		0.31	21	0	0.31	80	0.01
TOTAL FOR MAP NO. 15								0.31				80	0.01
2025CPT.06.05.20092.1	Bladen	16	SR-1171 / OLD ABBOTTSBURG RD	FROM NC 410 TO SR1003	1	2		4.73	22	0	4.73	296	0.10
TOTAL FOR MAP NO. 16								4.73				296	0.10
2025CPT.06.05.20092.1	Bladen	17	SR-1172 / GRIMSLEY FARM RD	FROM SR 1003 TO NC 211	1	2		3.28	20	0	3.28	188	0.07
TOTAL FOR MAP NO. 17								3.28				188	0.07
2025CPT.06.05.20092.1	Bladen	18	SR-1174 / 5TH ST	FROM SR 1171 TO SR 1175	1	2		0.99	20	0	0.99	48	0.02
TOTAL FOR MAP NO. 18								0.99				48	0.02
2025CPT.06.05.20092.1	Bladen	19	SR-1175 / 4TH ST	FROM NC 211 BUS TO SR 1174	1	2		0.38	21	0.04	0.42	24	0.01
TOTAL FOR MAP NO. 19								0.38				24	0.01
2025CPT.06.05.20092.1	Bladen	20	SR-1194 / OLD FIELD CEMETERY RD	FROM SR 1003 TO DEAD END	1	2		0.39	21	0	0.39	72	0.01
TOTAL FOR MAP NO. 20								0.39				72	0.01
TOTAL FOR PROJ NO. 2025CPT.06.05.20092.1								44.22				2,917	0.97
2025CPT.06.05.20092.2	Bladen	21	SR-1137 / MCKEE RD	FROM SR 1136 TO NC 211	3	2		1.3	21	0	1.3	72	0.02
TOTAL FOR MAP NO. 21								1.3				72	0.02
2025CPT.06.05.20092.2	Bladen	22	SR-1138 / BOOKER T WASHINGTON SCHOOL RD	FROM SR 1139 TO NC 211	3	2		0.84	19	0	0.84	72	0.01
TOTAL FOR MAP NO. 22								0.84				72	0.01
TOTAL FOR PROJ NO. 2025CPT.06.05.20092.2								2.14				144	0.030
GRAND TOTAL								46.36				3,061	1.00